

PRESICION ADAPTORS

		BNC		MMCX		MCX		SMPX		SK		QN		N	
		plug	jack	plug	jack	plug	jack	plug	jack	plug	jack	plug	jack	plug	jack
BNC	plug													201	202
	jack													203	200
MMCX	plug														
	jack														
MCX	plug														
	jack														
SMPX	plug										277				
	jack									274/275 276	271/272 273				
SK	plug								274/275 276						
	jack						277	271/272 273							
QN	plug														
	jack														
N	plug	201	203												
	jack	202	200												
PC24	plug									268	269				265
	jack									270	267			266	
PC35	plug					207	209							224	226/227
	jack					208	206							225	223
PC7		204	205									257	258	228/229	230/231 232
QMA	plug														234
	jack													235	233
SMA	plug			211	213									238	241 242
	jack			212	210									239/240	236/237 243
TNC	plug													245	247
	jack													246	244
41/95	plug													215	216
	jack													217	214
7/16	plug													220	222
	jack													221	219

Note:

The VSWR values stated for the precision Adaptors on the next pages are typical values!

		PC24		PC35		PC7	QMA		SMA		TNC		41/95		7/16	
		plug	jack	plug	jack		plug	jack	plug	jack	plug	jack	plug	jack	plug	jack
BNC	plug					204										
	jack					205										
MMCX	plug								211	212						
	jack								213	210						
MCX	plug			207	208											
	jack			209	206											
SMPX	plug															
	jack															
SK	plug	268	270													
	jack	267	269													
QN	plug					257										
	jack					258										
N	plug		266	224	225	228/229		235	238	239 240	245	246	215	217	220	221
	jack	265		226 227	223	230/231 232	234	233	241 242	236/237 243	247	244	216	214	222	219
PC24	plug															
	jack															
PC35	plug					248/255	250	251								
	jack					256	252	249								
PC7				248 255	256				259	260	261 262	263 264			253	254
QMA	plug			250	252											
	jack			251	249											
SMA	plug					259										
	jack					260										
TNC	plug					261/262										
	jack					263/264										
41/95	plug															218
	jack															
7/16	plug					253										
	jack					254						218				

Material and plating descriptions may refer to the connector housing or outer contact.

SUCO* = SUCOPLATE®
 SUPR** = SUCOPRO

200 H+S type
Item no. **31_BNC-N-50-51/1-_UE**
22544049

BNC
N jack (f)
jack (f)

Packaging: single

Material:
BNC: stainless steel
N: stainless steel

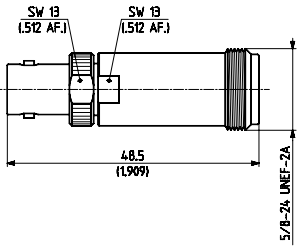

VSWR: DC - 4 GHz: $\leq 1.05 + 0.01f$

204 H+S type
Item no. **32_BNC-PC7-50-1/1-_UE**
22544047

BNC
PC7 plug (m)

Packaging: single

Material:
BNC: stainless steel
PC7: brass/gold

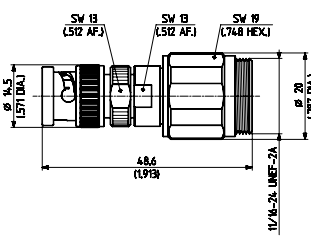

VSWR: DC - 4 GHz: $\leq 1.02 + 0.006f$

201 H+S type
Item no. **32_BNC-N-50-51/1-_UE**
22544051

BNC
N plug (m)
plug (m)

Packaging: single

Material:
BNC: stainless steel
N: stainless steel

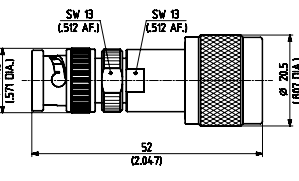

VSWR: DC - 4 GHz: $\leq 1.05 + 0.01f$

205 H+S type
Item no. **33_PC7-BNC-50-1/1-_UE**
22543918

PC7
BNC jack (f)

Packaging: single

Material:
PC7: brass/gold
BNC: stainless steel

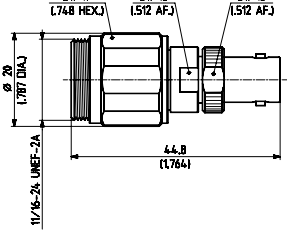

VSWR: DC - 4 GHz: $\leq 1.02 + 0.006f$

202 H+S type
Item no. **33_BNC-N-50-51/_UE**
22544052

BNC
N plug (m)
jack (f)

Packaging: single

Material:
BNC: stainless steel
N: stainless steel

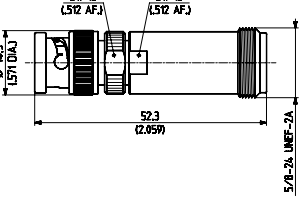

VSWR: DC - 4 GHz: $\leq 1.05 + 0.01f$

206 H+S type
Item no. **31_MCX-PC35-50-1/111_NE**
22651593

MCX
PC35 jack (f)
jack (f)

Packaging: single

Material:
MCX: CuBe/SUPR**
PC35: CuBe/SUPR**

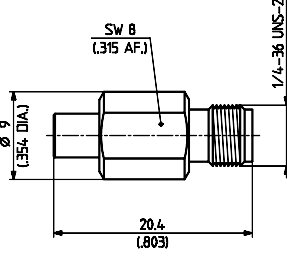

VSWR: DC - 3 GHz: ≤ 1.065 ; 3 - 6 GHz: ≤ 1.09

203 H+S type
Item no. **33_N-BNC-50-51/1-_UE**
22544050

N
BNC plug (m)
jack (f)

Packaging: single

Material:
N: stainless steel
BNC: stainless steel

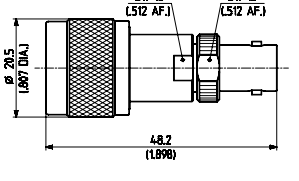

VSWR: DC - 4 GHz: $\leq 1.05 + 0.01f$

207 H+S type
Item no. **32_MCX-PC35-50-1/111_NE**
22651600

MCX
PC35 plug (m)
plug (m)

Packaging: single

Material:
MCX: CuBe/SUPR**
PC35: CuBe/SUPR**

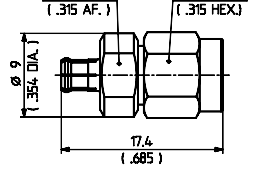

VSWR: DC - 3.5 GHz: ≤ 1.07 ; 3.5 - 6 GHz: ≤ 1.09

Material and plating descriptions may refer to the connector housing or outer contact.

SUCO* = SUCOPLATE®
SUPR** = SUCOPRO

208 H+S type Item no. 33_MCX-PC35-50-1/111_NE 22651594

MCX PC35 plug (m) jack (f)
 Packaging single
 Material: MCX CuBe/SUPR** PC35 CuBe/SUPR**

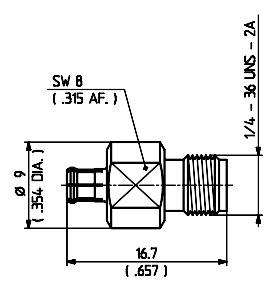

VSWR: DC - 3.5 GHz: ≤ 1.065
 3.5 - 6 GHz: ≤ 1.094

212 H+S type Item no. 33_MM CX-SMA-50-2/111_NE 22658203

MMCX SMA plug (m) jack (f)
 Packaging single
 Material: MMCX CuBe/SUPR** SMA CuBe

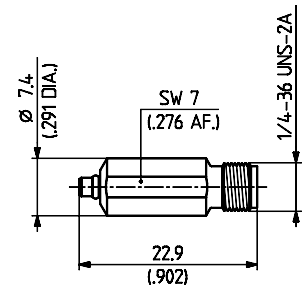

VSWR: DC - 3.5 GHz: ≤ 1.065;
 3.5 - 6 GHz: ≤ 1.094

209 H+S type Item no. 33_PC35-MCX-50-1/111_NE 22651599

PC35 MCX plug (m) jack (f)
 Packaging single
 Material: PC35 CuBe/SUPR** MCX CuBe/SUPR**

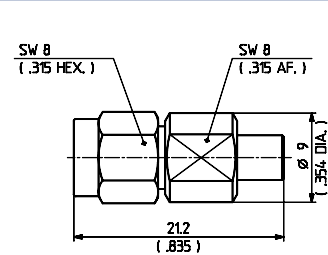

VSWR: DC - 3.5 GHz: ≤ 1.065
 3.5 - 6 GHz: ≤ 1.094

213 H+S type Item no. 33_SMA-MM CX-50-2/111_NE 22658204

SMA MMCX plug (m) jack (f)
 Packaging single
 Material: SMA CuBe/SUPR** MMCX CuBe/SUPR**

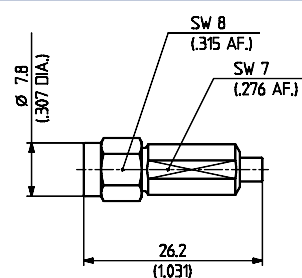

VSWR: DC - 3.5 GHz: ≤ 1.065
 3.5 - 6 GHz: ≤ 1.094

210 H+S type Item no. 31_MM CX-SMA-50-2/111_NE 22658201

MMCX SMA jack (f) jack (f)
 Packaging single
 Material: MMCX CuBe/SUPR** SMA CuBe/SUPR**

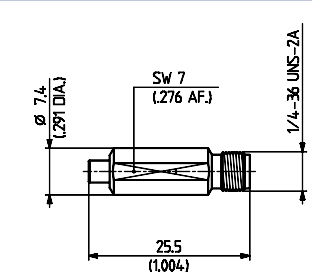

VSWR: DC - 3.5 GHz: ≤ 1.07
 3.5 - 6 GHz: ≤ 1.09

214 H+S type Item no. 31_N-4195-50-12/139_UE 22646160

N 41/95 jack (f) jack (f)
 Packaging single
 Material: N stainless steel 41/95 brass/SUCO*

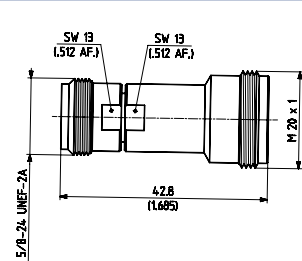

VSWR: DC - 6 GHz: ≤ 1.05; 6 - 14 GHz: ≤ 1.12

211 H+S type Item no. 32_MM CX-SMA-50-2/111_NE 22658202

MMCX SMA plug (m) plug (m)
 Packaging single
 Material: MMCX CuBe/SUPR** SMA CuBe/SUPR**

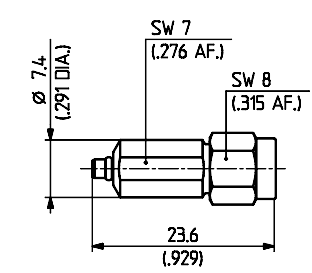

VSWR: DC - 3.5 GHz: ≤ 1.07; 3.5 - 6 GHz: ≤ 1.09

215 H+S type Item no. 32_4195-N-50-1/1-UE 22650781

41/95 N plug (m) plug (m)
 Packaging single
 Material: 41/95 brass/SUCO* N stainless steel

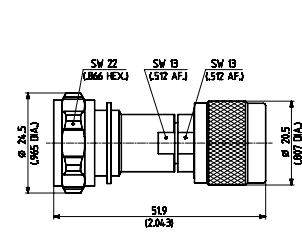

VSWR: DC - 14 GHz: ≤ 1.06

Material and plating descriptions may refer to the connector housing or outer contact.

SUCO* = SUCOPLATE®
 SUPR** = SUCOPRO

216 H+S type Item no. 33_4195-N-50-1/-_UE 22646154

41/95 N plug (m) jack (f)

Packaging: single

Material: 41/95 N brass/SUCO* stainless steel

VSWR: DC - 6 GHz: ≤ 1.05; 6 - 14 GHz: ≤ 1.12

220 H+S type Item no. 32_N-716-50-51/-33_NE 22544127

N 7/16 plug (m) plug (m)

Packaging: single

Material: N 7/16 brass/silver brass/silver

VSWR: DC - 7.5 GHz: ≤ 1.03 + 0.004f

217 H+S type Item no. 33_N-4195-50-51/1-3_UE 22648618

N 41/95 plug (m) jack (f)

Packaging: single

Material: N 41/95 stainless steel brass/SUCO*

VSWR: DC - 6 GHz: ≤ 1.05; 6 - 14 GHz: ≤ 1.12

221 H+S type Item no. 33_N-716-50-51/-33_NE 22544123

N 7/16 plug (m) jack (f)

Packaging: single

Material: N 7/16 brass/SUCO* brass/SUCO*

VSWR: DC - 7.5 GHz: ≤ 1.03 + 0.004f

218 H+S type Item no. 33_4195-716-50-1/-33_NE 22650069

41/95 7/16 plug (m) jack (f)

Packaging: single

Material: 41/95 7/16 brass/SUCO* brass/SUCO*

VSWR: DC - 7.5 GHz: ≤ 1.06

222 H+S type Item no. 33_716-N-50-51/-33_NE 22544125

7/16 N plug (m) jack (f)

Packaging: single

Material: 7/16 N brass/SUCO* brass/SUCO*

VSWR: DC - 7.5 GHz: ≤ 1.03 + 0.004f

219 H+S type Item no. 31_N-716-50-51/-33_NE 22544129

N 7/16 jack (f) jack (f)

Packaging: single

Material: N 7/16 brass/SUCO* brass/SUCO*

VSWR: DC - 7.5 GHz: ≤ 1.03 + 0.004f

223 H+S type Item no. 31_N-PC35-50-1/1-_UE 22643960

N PC35 jack (f) jack (f)

Packaging: single

Material: N PC35 stainless steel stainless steel

VSWR: DC - 12.4 GHz: ≤ 1.10
12.4 - 18 GHz: ≤ 1.15

Material and plating descriptions may refer to the connector housing or outer contact.

SUCO* = SUCOPLATE®
SUPR** = SUCOPRO

224 H+S type Item no. 32_N-PC35-50-1/1-UE 22643957

N
PC35
plug (m)
plug (m)
Packaging: single
Material:
N: stainless steel
PC35: stainless steel

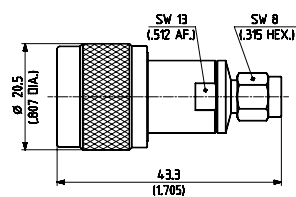

VSWR: DC - 12.4 GHz: ≤ 1.10
12.4 - 18 GHz: ≤ 1.15

228 H+S type Item no. 32_N-PC7-50-1/1-UE 22543571

N
PC7
plug (m)
Packaging: single
Material:
N: stainless steel
PC7: brass/gold

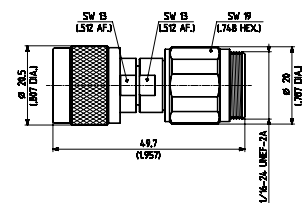

VSWR: DC - 18 GHz: ≤ 1.02 + 0.002f

225 H+S type Item no. 33_N-PC35-50-1/1-UE 22643959

N
PC35
plug (m)
jack (f)
Packaging: single
Material:
N: stainless steel
PC35: stainless steel

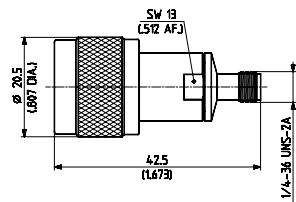

VSWR: DC - 12.4 GHz: ≤ 1.10
12.4 - 18 GHz: ≤ 1.15

229 H+S type Item no. 32_N-PC7-50-6/1-NE 23032917

N
PC7
plug (m)
Packaging: single
Material:
N: stainless steel
PC7: brass/gold
El. length: typ. 41.85mm

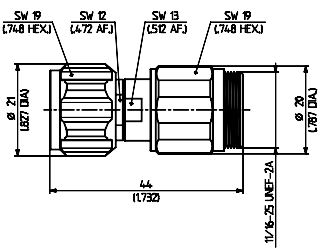

VSWR: DC - 3 GHz: ≤ 1.03; 3 - 6 GHz: ≤ 1.05
6 - 11 GHz: ≤ typ. 1.12

226 H+S type Item no. 33_PC35-N-50-1/1-UE 22643958

PC35
N
plug (m)
jack (f)
Packaging: single
Material:
PC35: stainless steel
N: stainless steel

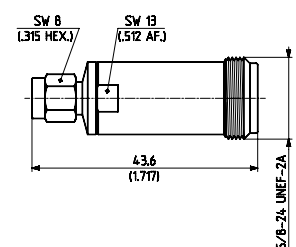

VSWR: DC - 12.4 GHz: ≤ 1.10
12.4 - 18 GHz: ≤ 1.15

230 H+S type Item no. 33_PC7-N-50-1/1-UE 22543547

PC7
N
jack (f)
Packaging: single
Material:
PC7: brass/gold
N: stainless steel

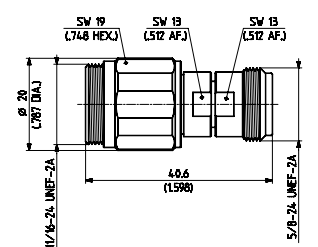

VSWR: DC - 18 GHz: ≤ 1.02 + 0.002f

227 H+S type Item no. 39_PC35-N-50-1/1-UE 22660363

PC35
N
plug (m)
jack (f)
Packaging: single
Material:
PC35: stainless steel
N: stainless steel

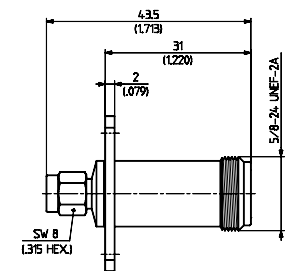

VSWR: DC - 12.4 GHz: ≤ 1.10
12.4 - 18 GHz: ≤ 1.15

231 H+S type Item no. 33_PC7-N-50-5/33_NE 23004036

PC7
N
jack (f)
Packaging: single
Material:
PC7: brass/gold
N: stainless steel

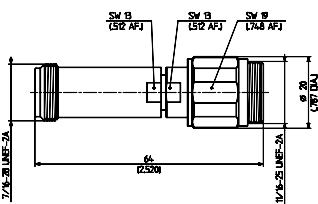

VSWR: DC - 18 GHz: ≤ 1.03 + 0.002f

Material and plating descriptions may refer to the connector housing or outer contact.

SUCO* = SUCOPLATE®
SUPR** = SUCOPRO

232 H+S type Item no. **33_PC7-N-50-6/1-NE** 23032916

PC7
N jack (f)
Packaging single
Material:
PC7 brass/gold
N stainless steel
El. length: typ. 41.85mm

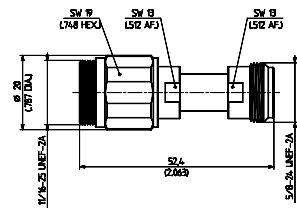

VSWR: DC - 3 GHz: ≤ 1.03; 3 - 6 GHz: ≤ 1.05
6 - 11 GHz: ≤ typ. 1.12

233 H+S type Item no. **31_N-QMA-50-1/1-NE** 23027960

N jack (f)
QMA jack (f)
Packaging single
Material:
N stainless steel
QMA stainless steel

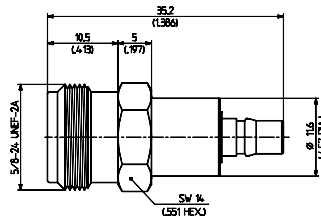

VSWR: DC - 2.5 GHz: ≤ 1.036
2.5 - 6 GHz: ≤ 1.135

234 H+S type Item no. **33_QMA-N-50-1/133_NE** 23023143

QMA plug (m)
N jack (f)
Packaging single
Material:
QMA brass/SUCO*
N brass/SUCO*

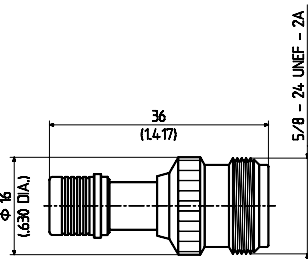

VSWR: DC - 6 GHz: ≤ 1.04

235 H+S type Item no. **33_N-QMA-50-1/133_NE** 23024265

N plug (m)
QMA jack (f)
Packaging single
Material:
N brass/SUCO*
QMA brass/SUCO*

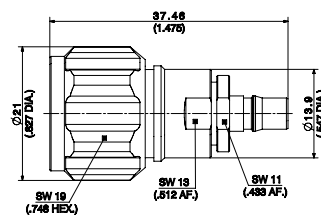

VSWR: DC - 6 GHz: ≤ 1.04

236 H+S type Item no. **31_N-SMA-50-51/1-UE** 22543928

N jack (f)
SMA jack (f)
Packaging single
Material:
N stainless steel
SMA CuBe/SUPR**

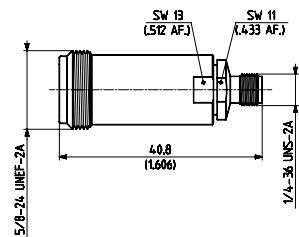

VSWR: DC - 18 GHz: ≤ 1.025 + 0.007f

237 H+S type Item no. **31_N-SMA-50-51/1-NE** 22660178

N jack (f)
SMA jack (f)
Packaging single
Material:
N stainless steel
SMA CuBe/gold

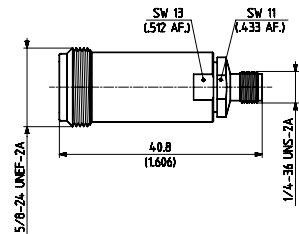

VSWR: DC - 18 GHz: ≤ 1.025 + 0.007f

238 H+S type Item no. **32_N-SMA-50-51/1-UE** 22543916

N plug (m)
SMA plug (m)
Packaging single
Material:
N stainless steel
SMA CuBe/gold

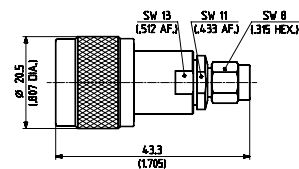

VSWR: DC - 18 GHz: ≤ 1.025 + 0.007f

239 H+S type Item no. **33_N-SMA-50-51/1-UE** 22543925

N plug (m)
SMA jack (f)
Packaging single
Material:
N stainless steel
SMA CuBe/gold

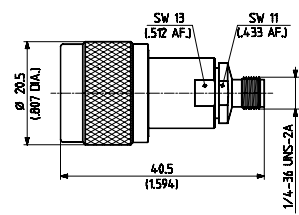

VSWR: DC - 18 GHz: ≤ 1.025 + 0.007f

Material and plating descriptions may refer to the connector housing or outer contact.

SUCO* = SUCOPLATE®
SUPR** = SUCOPRO

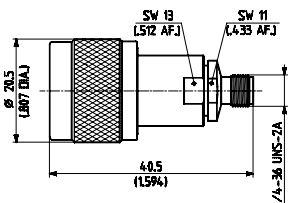
240	H+S type Item no.	33_N-SMA-50-51/1_-NE 22660180
N SMA	plug (m) jack (f)	
Packaging	single	
Material: N SMA	stainless steel CuBe/gold	
VSWR:	DC - 18 GHz: $\leq 1.025 + 0.007f$	

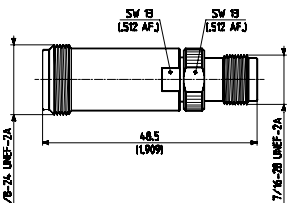
244	H+S type Item no.	31_N-TNC-50-51/1_-UE 22543954
N TNC	jack (f) jack (f)	
Packaging	single	
Material: N TNC	stainless steel stainless steel	
VSWR:	DC - 12.4 GHz: $\leq 1.05 + 0.01f$	

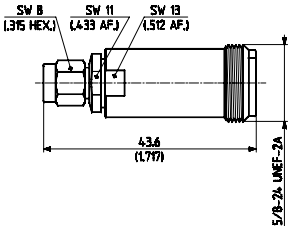
241	H+S type Item no.	33_SMA-N-50-51/1_-UE 22543926
SMA N	plug (m) jack (f)	
Packaging	single	
Material: SMA N	CuBe/gold stainless steel	
VSWR:	DC - 18 GHz: $\leq 1.025 + 0.007f$	

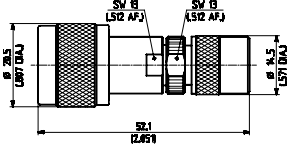
245	H+S type Item no.	32_N-TNC-50-51/1_-UE 22543953
N TNC	plug (m) plug (m)	
Packaging	single	
Material: N TNC	stainless steel stainless steel	
VSWR:	DC - 12.4 GHz: $\leq 1.05 + 0.01f$	

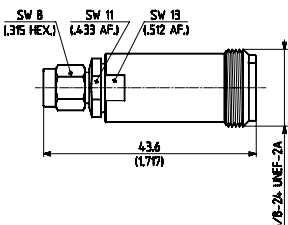
242	H+S type Item no.	33_SMA-N-50-51/1_-NE 22660181
SMA N	plug (m) jack (f)	
Packaging	single	
Material: SMA N	CuBe/gold stainless steel	
VSWR:	DC - 18 GHz: $\leq 1.025 + 0.007f$	

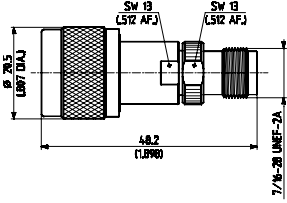
246	H+S type Item no.	33_N-TNC-50-51/1_-UE 22543955
N TNC	plug (m) jack (f)	
Packaging	single	
Material: N TNC	stainless steel stainless steel	
VSWR:	DC - 12.4 GHz: $\leq 1.05 + 0.01f$	

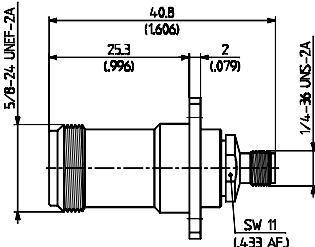
243	H+S type Item no.	37_N-SMA-50-51/1_-NE 22645162
N SMA	jack (f) jack (f)	
Packaging	single	
Material: N SMA	stainless steel CuBe/gold	
VSWR:	DC - 18 GHz: $\leq 1.025 + 0.007f$	

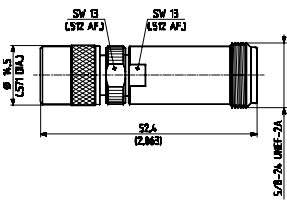
247	H+S type Item no.	33_TNC-N-50-51/-_UE 22544046
TNC N	plug (m) jack (f)	
Packaging	single	
Material: TNC N	stainless steel stainless steel	
VSWR:	DC - 12.4 GHz: $\leq 1.05 + 0.01f$	

248	H+S type Item no.	32_PC35-PC7-50-3/-33_NE 23003902
PC35 PC7	plug (m)	
Packaging	single	
Material: PC35 PC7	brass/SUCO* brass/gold	
VSUR:	DC - 18 GHz: ≤ 1.06	

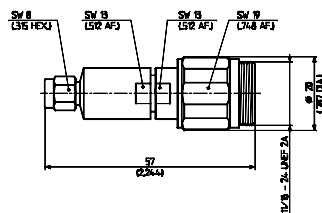

252	H+S type Item no.	33_QMA-PC35-50-1/1-NE 23017488
QMA PC35	plug (m) jack (f)	
Packaging	single	
Material: QMA PC35 El. length:	stainless steel stainless steel 25.4 ± 2.6 mm	
VSUR:	DC - 1.5 GHz: ≤ 1.036 ; 1.5 - 6 GHz: ≤ 1.065 6 - 18 GHz: ≤ 1.22	

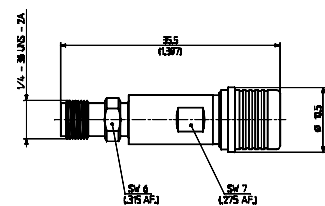

249	H+S type Item no.	31_PC35-QMA-50-1/199_NE 23017468
PC35 QMA	jack (f) jack (f)	
Packaging	single	
Material: PC35 QMA El. length:	stainless steel stainless steel 25.4 ± 2.6 mm	
VSUR:	DC - 1.5 GHz: ≤ 1.036 ; 1.5 - 6 GHz: ≤ 1.065 6 - 18 GHz: ≤ 1.22	

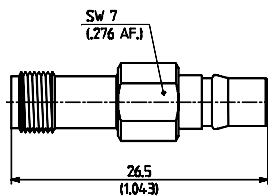

253	H+S type Item no.	32_PC7-716-50-1/-3_NE 22544128
PC7 7/16	plug (m)	
Packaging	single	
Material: PC7 7/16	brass/SUPR** brass/SUCO*	
VSUR:	DC - 7.5 GHz: $\leq 1.03 + 0.004f$	

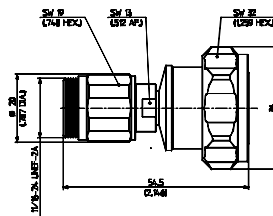

250	H+S type Item no.	32_PC35-QMA-50-1/1-NE 23017489
PC35 QMA	plug (m) plug (m)	
Packaging	single	
Material: PC35 QMA El. length:	stainless steel st. steel/brass 25.4 ± 2.6 mm	
VSUR:	DC - 1.5 GHz: ≤ 1.036 ; 1.5 - 6 GHz: ≤ 1.065 6 - 18 GHz: ≤ 1.22	

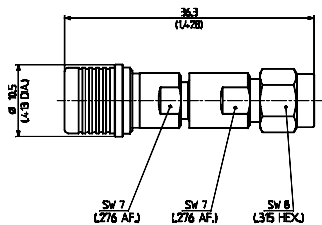

254	H+S type Item no.	33_PC7-716-50-1/-3_NE 22544126
PC7 7/16	jack (f)	
Packaging	single	
Material: PC7 7/16	brass/SUPR** brass/SUCO*	
VSUR:	DC - 7.5 GHz: $\leq 1.03 + 0.004f$	

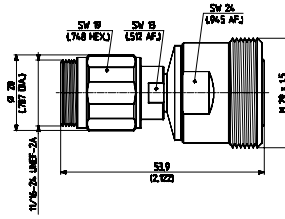

251	H+S type Item no.	33_PC35-QMA-50-1/199_NE 23017467
PC35 QMA	plug (m) jack (f)	
Packaging	single	
Material: PC35 QMA El. length:	stainless steel stainless steel 25.4 ± 2.6 mm	
VSUR:	DC - 1.5 GHz: ≤ 1.036 ; 1.5 - 6 GHz: ≤ 1.065 6 - 18 GHz: ≤ 1.22	

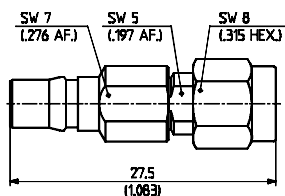

255	H+S type Item no.	32_PC7-PC35-50-1/1-UE 22644230
PC7 PC35	plug (m)	
Packaging	single	
Material: PC7 PC35	brass/gold stainless steel	
VSUR:	DC - 15 GHz: ≤ 1.05 ; 15 - 18 GHz: ≤ 1.09	

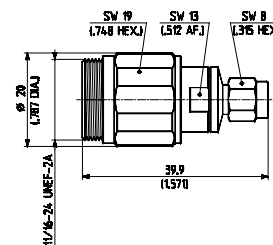

Material and plating descriptions may refer to the connector housing or outer contact.

SUCO* = SUCOPLATE®
SUPR** = SUCOPRO

256 H+S type 33_PC7-PC35-50-1/1-_UE
Item no. 22644231

**PC7
PC35** jack (f)
Packaging single
Material:
PC7 brass/gold
PC35 stainless steel

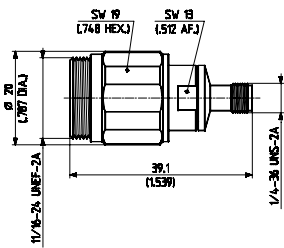

VSWR: DC - 15 GHz: ≤ 1.05 ; 15 - 18 GHz: ≤ 1.09

260 H+S type 33_PC7-SMA-50-1/1-_UE
Item no. 22543548

**PC7
SMA** jack (f)
Packaging single
Material:
PC7 brass/gold
SMA CuBe/gold

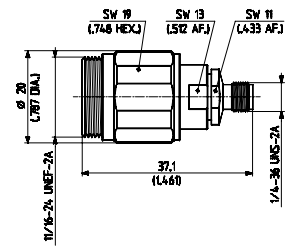

VSWR: DC - 18 GHz: $\leq 1.025 + 0.002f$

257 H+S type 32_PC7-QN-50-1/1-_NE
Item no. 23032720

**PC7
QN** plug (m)
Packaging single
Material:
PC7 brass/gold
QN stainless steel
El. length: typ. 41.85mm

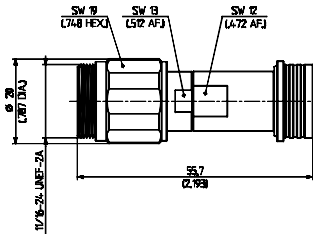

VSWR: DC - 3 GHz: ≤ 1.03 ; 3 - 6 GHz: ≤ 1.05
6 - 11 GHz: \leq typ. 1.12

261 H+S type 32_PC7-TNC-50-1/1-_UE
Item no. 22544048

**PC7
TNC** plug (m)
Packaging single
Material:
PC7 brass/gold
TNC stainless steel

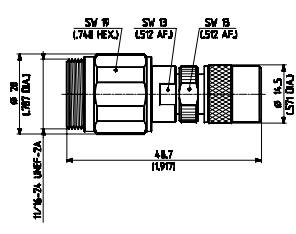

VSWR: DC - 12.4 GHz: $\leq 1.02 + 0.009f$

258 H+S type 33_PC7-QN-50-1/1-_NE
Item no. 23032722

**PC7
QN** jack (f)
Packaging single
Material:
PC7 brass/gold
QN stainless steel
El. length: typ. 41.85mm

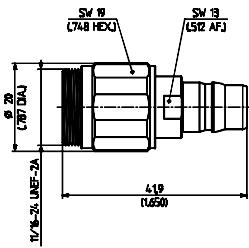

VSWR: DC - 3 GHz: ≤ 1.03 ; 3 - 6 GHz: ≤ 1.05
6 - 11 GHz: \leq typ. 1.12

262 H+S type 32_PC7-TNC-50-52/-33_NE
Item no. 23003983

**PC7
TNC** plug (m)
Packaging single
Material:
PC7 brass/gold
TNC stainless steel

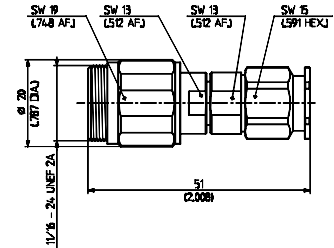

VSWR: DC - 18 GHz: $\leq 1.03 + 0.009f$

259 H+S type 32_PC7-SMA-50-1/-_UE
Item no. 22543546

**PC7
SMA** plug (m)
Packaging single
Material:
PC7 brass/gold
SMA CuBe/gold

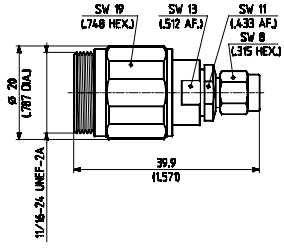

VSWR: DC - 18 GHz: $\leq 1.025 + 0.002f$

263 H+S type 33_PC7-TNC-50-51/11-_UE
Item no. 22643455

**PC7
TNC** jack (f)
Packaging single
Material:
PC7 brass/SUCO*
TNC stainless steel

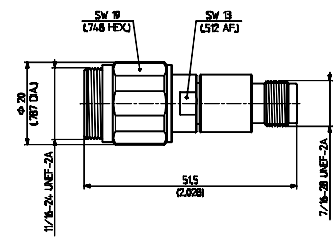

VSWR: DC - 18 GHz: $\leq 1.05 + 0.005f$

Material and plating descriptions may refer to the connector housing or outer contact.

SUCO* = SUCOPLATE®
SUPR** = SUCOPRO

264 H+S type
Item no. 33_PC7-TNC-50-52/33_NE
23003920

**PC7
TNC** jack (f)

Packaging: single

Material:
PC7: brass/gold
TNC: stainless steel

VSWR: DC - 18 GHz: $\leq 1.03 + 0.009f$

268 H+S type
Item no. 32_PC24-SK-50-1/199_NE
23004729

**PC24
SK** plug (m)
plug (m)

Packaging: single

Material:
PC24: stainless steel
SK: stainless steel
El. length: 16.1 ± 0.1 mm

VSWR: DC - 40 GHz: ≤ 1.12

265 H+S type
Item no. 33_PC24-N-50-1/199_NE
22650021

**PC24
N** plug (m)
jack (f)

Packaging: single

Material:
PC24: stainless steel
N: stainless steel

VSWR: DC - 10 GHz: ≤ 1.05 ; 10 - 18 GHz: ≤ 1.08

269 H+S type
Item no. 33_PC24-SK-50-2/199_NE
23004730

**PC24
SK** plug (m)
jack (f)

Packaging: single

Material:
PC24: stainless steel
SK: stainless steel
El. length: 16.1 ± 0.1 mm

VSWR: DC - 40 GHz: ≤ 1.12

266 H+S type
Item no. 33_N-PC24-50-1/199_UE
22649932

**N
PC24** plug (m)
jack (f)

Packaging: single

Material:
N: stainless steel
PC24: stainless steel

VSWR: DC - 10 GHz: ≤ 1.05 ; 10 - 18 GHz: ≤ 1.08

270 H+S type
Item no. 33_SK-PC24-50-1/199_NE
23004731

**SK
PC24** plug (m)
jack (f)

Packaging: single

Material:
PC24: stainless steel
SK: stainless steel
El. length: 16.1 ± 0.1 mm

VSWR: DC - 40 GHz: ≤ 1.12

267 H+S type
Item no. 31_PC24-SK-50-1/199_NE
84008075

**PC24
SK** jack (f)
jack (f)

Packaging: single

Material:
PC24: stainless steel
SK: stainless steel

VSWR: DC - 40 GHz: ≤ 1.12

271 H+S type
Item no. 31_SK-SMPX-50-1/199_NE
23021816

**SK
SMPX** jack (f)
jack (f)

Packaging: single

Material:
SK: stainless steel
SMPX: stainless steel

Note: full detent

VSWR: DC - 15 GHz: ≤ 1.105 ; 15 - 30 GHz: ≤ 1.152
30 - 40 GHz: ≤ 1.222

Material and plating descriptions may refer to the connector housing or outer contact.

SUCO* = SUCOPLATE®
SUPR** = SUCOPRO

272 H+S type 31_SK-SMPX-50-2/199_NE
Item no. 23021817

SK SMPX jack (f)
jack (f)

Packaging: single

Material:
SK: stainless steel
SMPX: stainless steel

Note: limited detent

VSWR: DC - 15 GHz: ≤ 1.105; 15 - 30 GHz: ≤ 1.152
30 - 40 GHz: ≤ 1.222

276 H+S type 33_SK-SMPX-50-3/199_NE
Item no. 23021793

SK SMPX plug (m)
jack (f)

Packaging: single

Material:
SK: stainless steel
SMPX: stainless steel

Note: smooth bore

VSWR: DC - 15 GHz: ≤ 1.105; 15 - 30 GHz: ≤ 1.152
30 - 40 GHz: ≤ 1.222

273 H+S type 31_SK-SMPX-50-3/199_NE
Item no. 23021818

SK SMPX jack (f)
jack (f)

Packaging: single

Material:
SK: stainless steel
SMPX: stainless steel

Note: smooth bore

VSWR: DC - 15 GHz: ≤ 1.105; 15 - 30 GHz: ≤ 1.152
30 - 40 GHz: ≤ 1.222

277 H+S type 33_SMPX-SK-50-1/199_NE
Item no. 23032847

SMPX SK plug (m)
jack (f)

Packaging: single

Material:
SMPX: stainless steel
SK: stainless steel

VSWR: DC - 12 GHz: ≤ 1.05; 12 - 40 GHz: ≤ 1.2

274 H+S type 33_SK-SMPX-50-1/199_NE
Item no. 23021753

SK SMPX plug (m)
jack (f)

Packaging: single

Material:
SK: stainless steel
SMPX: stainless steel

smooth bore full detent

VSWR: DC - 15 GHz: ≤ 1.105; 15 - 30 GHz: ≤ 1.152
30 - 40 GHz: ≤ 1.222

275 H+S type 33_SK-SMPX-50-2/199_NE
Item no. 23021792

SK SMPX plug (m)
jack (f)

Packaging: single

Material:
SK: stainless steel
SMPX: stainless steel

Note: limited detent

VSWR: DC - 15 GHz: ≤ 1.105; 15 - 30 GHz: ≤ 1.152
30 - 40 GHz: ≤ 1.222